

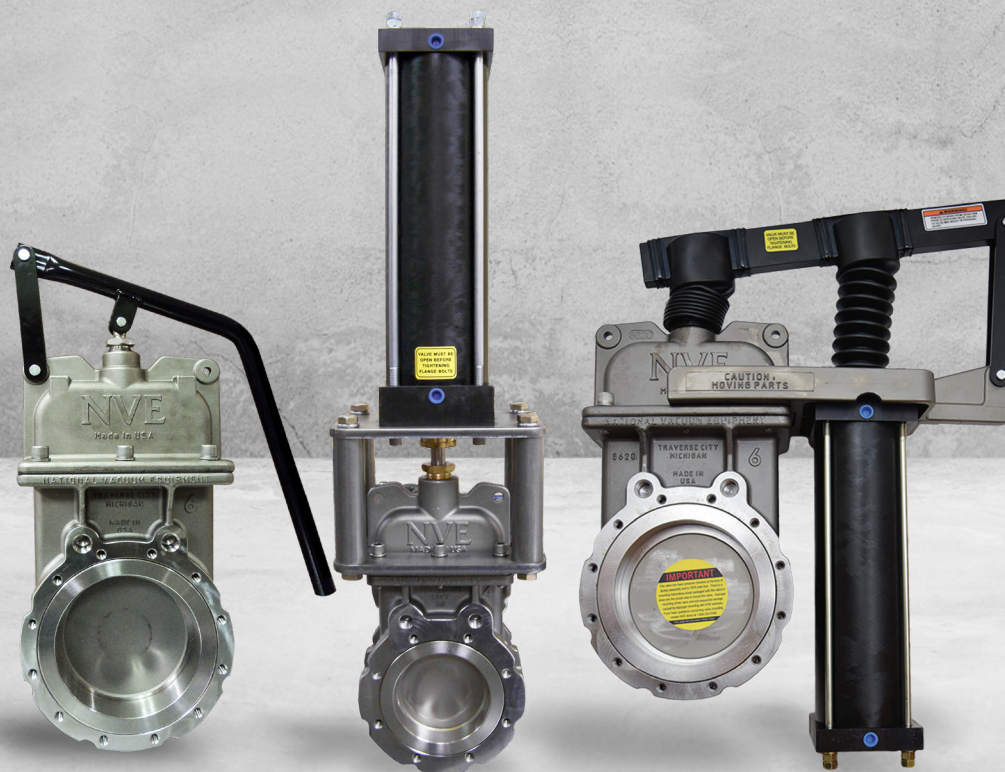

NVE VALVES

Designed. Built. Supported in the USA.



Challenger Series
VACUUM PUMPS & BLOWERS

Weights and measurements are
for reference only

800-253-5500 | www.natvac.com

NVE

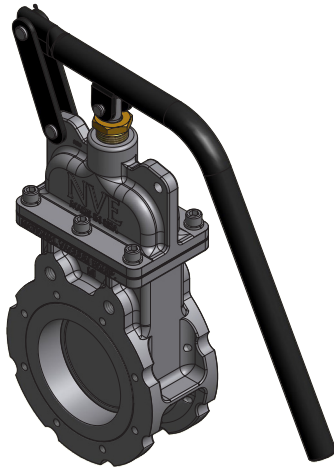

NVE Single Gate Valve | Manual Actuation Steel

- Stainless Steel Stem, Seat, Gate and Guide are Standard
- Viton Seals Standard; Viton O-Ring Seal on Seat
- Other O-Ring Materials Available
- Completely Re-buildable and Self-Cleaning; accepts TTMA and ANSI Flanges MAWP 100 PSI
- Burst Pressure greater than 400 PSI
- Available in 4" and 6"

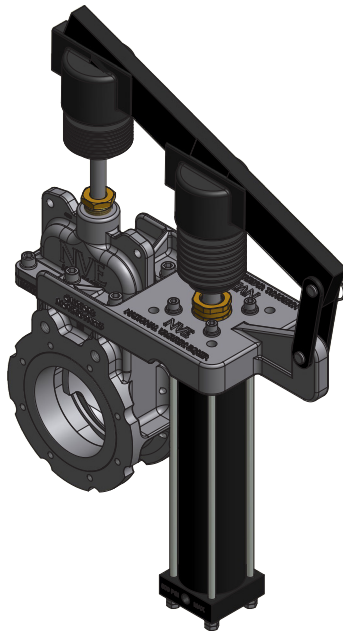

NVE Valves with Actuators | Hydraulic Spring Closed

- Steel or Stainless Steel Body; Stainless Steel Stem, Seat, Gate and Guide are Standard
- Viton Seals Standard; Viton O-Ring Seal on Seat; Other O-Ring Materials Available
- Completely Re-buildable and Self-Cleaning; accepts TTMA and ANSI Flanges
- MAWP 100 PSI; Burst Pressure greater than 400 PSI
- Available in 4" and 6"

Actuator

- Assembly features Stainless Steel Bracket and Fasteners; Powder Coat Painted Parts
- Replaceable Seals; and a Million-Cycle Spring. Maximum Cylinder Operating Pressure 500 PSI

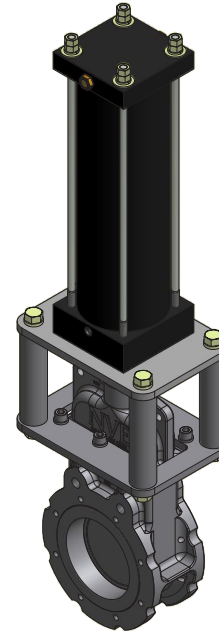

NVE Valves with Actuators | Pneumatic Spring Closed

- Steel or Stainless Steel Body; Stainless Steel Stem, Seat, Gate and Guide are Standard
- Viton Seals Standard; Viton O-Ring Seal on Seat; Other O-Ring Materials Available
- Completely Re-buildable and Self-Cleaning; accepts TTMA and ANSI Flanges
- MAWP 100 PSI; Burst Pressure greater than 400 PSI
- Available in 4" and 6"

Actuator

- Assembly features Stainless Steel Bracket and Fasteners; Powder Coat Painted Parts
- Self-Lubricating Cylinder; Replaceable Seals; and a Million-Cycle Spring
- Maximum Cylinder Operating Pressure 150 PSI