

Float Level Indicator with Weldable Sleeve

Drill or cut a 2" diameter hole in the side of the tank. Position the weld sleeve in the hole. Slide the weld sleeve forward to the end of machined area and weld the sleeve in place. From the top or inside of tank slide the float arm weldment into the sleeve.

Install the bearing, large internal snap ring, washer, and 5/8" nut onto the float arm. Next, install the small internal snap ring and the indicator arrow. Position the indicator arrow in the position desired and then tighten set screws. Grease the grease fitting.

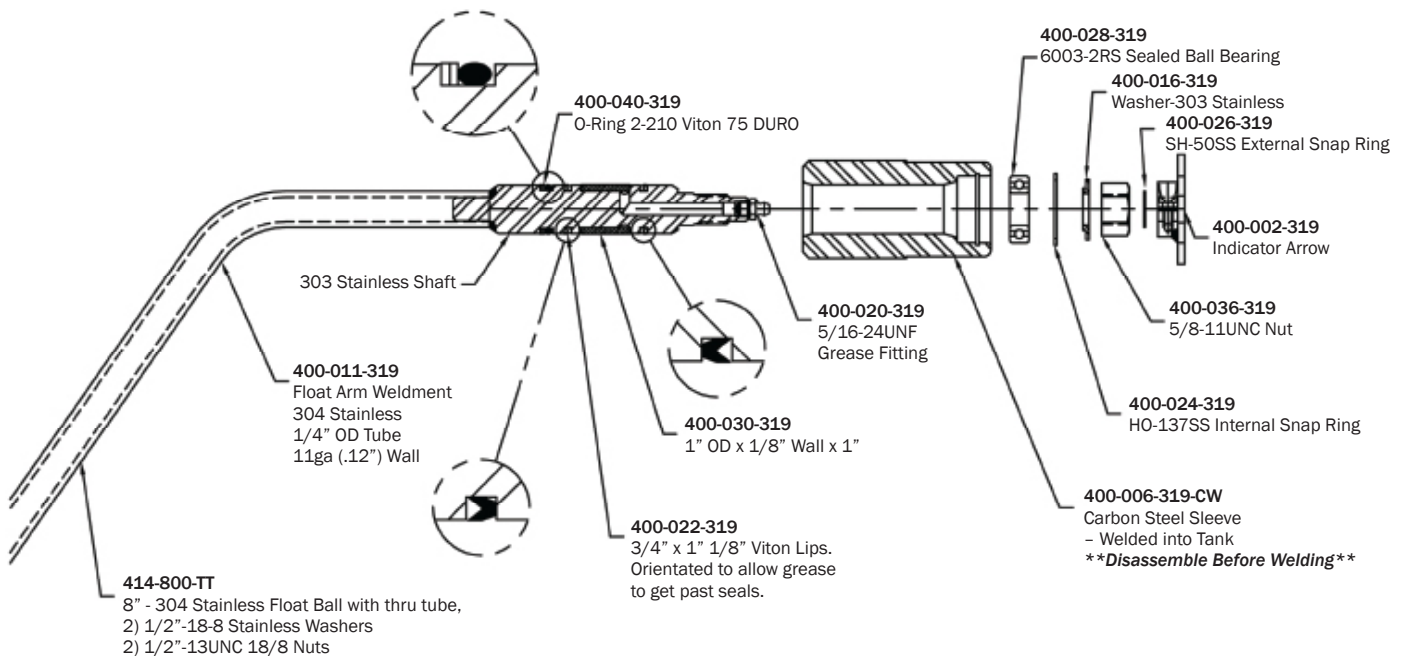

NVE manufactures the float level indicator in 3 different models.

- Float level indicator with carbon steel sleeve (Part # 400-319-8CW); (ASME Part# 400-320-8CW)
- Float level indicator with stainless steel sleeve (Part # 400-319-8SW); (ASME Part# 400-320-8SW)
- Float level indicator with aluminum sleeve (Part # 400-319-8AW); (ASME Part# 400-320-8AW)

WARNING: The Float level indicator with the carbon steel, stainless steel and/or aluminum weld sleeve must be disassembled before installation. Failure to do so will cause heat damage to the internal components of the float level indicator.

The float level Indicator should be installed in the center line of the side of the tank. Failure to do so may cause leakage.

Challenger Vacuum Pump & Pump Packages | Blowers & Blower Packages
Self Contained Pump Packages | Battioni Pagani Pumps & Packages
Rotary Lobe Blowers | DOT Manufactured Valves | RIV Imported Valves
Vacuum Tank Components | Accessories

800.253.5500 | www.natvac.com

Installation Instructions NVE Float Level Indicator

Float Level Indicator with Threaded Bushing and Nut

Drill or cut a 2" diameter hole in the side of the tank. Remove the 2" nut and stainless washer from the float level indicator. Leave the Viton gasket on the float level indicator. From the top or the inside of the tank, slide the float level indicator with the threaded bushing thru the previous cut hole. Next, slide the stainless washer onto the threaded bushing. Then, thread on the 2" jam nut and tighten to secure.

Slide the float arm weldment into the sleeve. Then install the bearing, large internal snap ring, washer, and 5/8" nut onto the float arm. Next, install the small internal snap ring and the indicator arrow. Position the indicator arrow in the position desired and then tighten set screws. Grease the grease fitting.

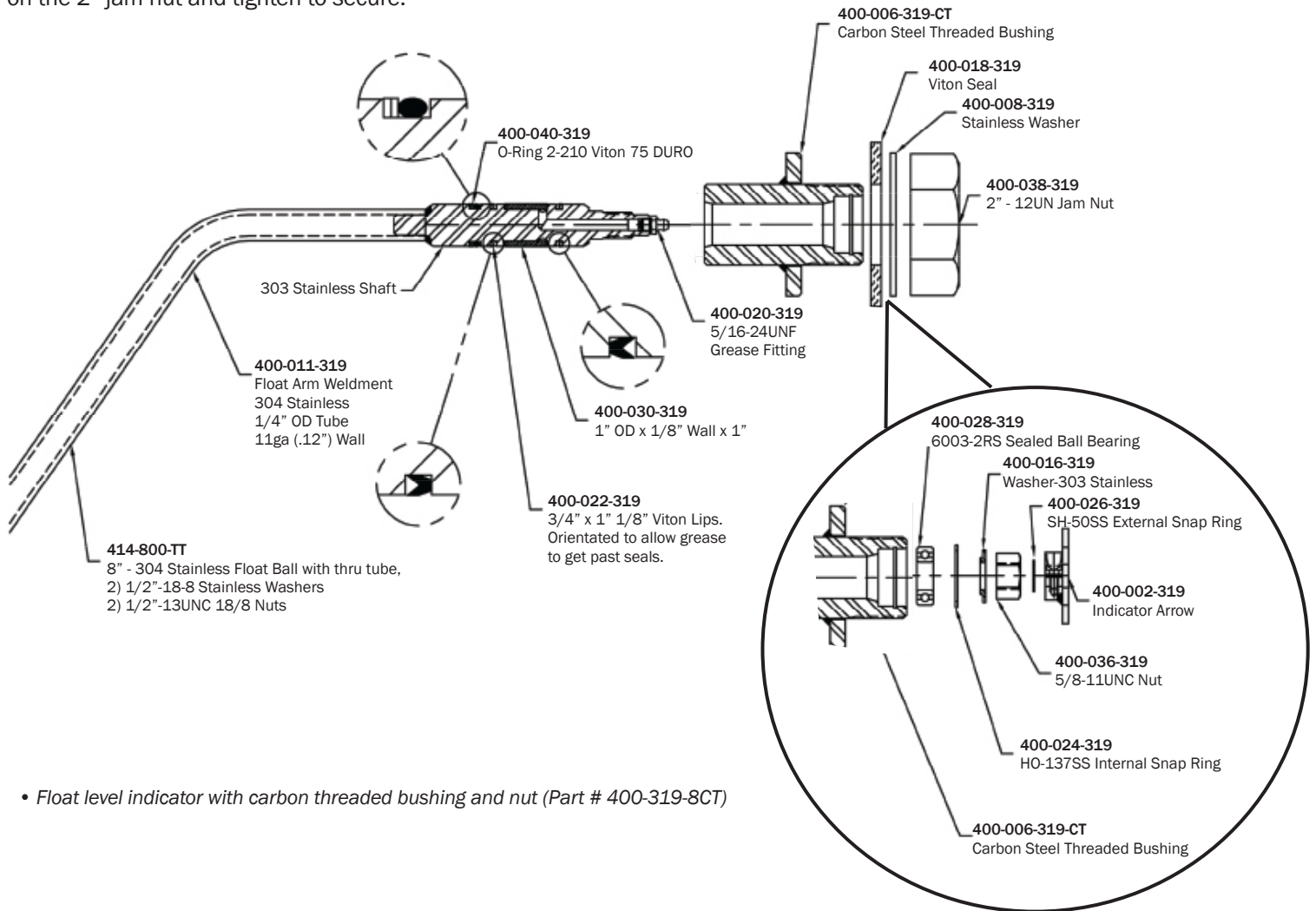

• Float level indicator with carbon threaded bushing and nut (Part # 400-319-8CT)

WARNING: The Float level indicator with the carbon steel, stainless steel and/or aluminum weld sleeve must be disassembled before installation. Failure to do so will cause heat damage to the internal components of the float level indicator.

The float level Indicator should be installed in the center line of the side of the tank. Failure to do so may cause leakage.

Challenger Vacuum Pump & Pump Packages | Blowers & Blower Packages
Self Contained Pump Packages | Battioni Pagani Pumps & Packages
Rotary Lobe Blowers | DOT Manufactured Valves | RIV Imported Valves
Vacuum Tank Components | Accessories

800.253.5500 | www.natvac.com